

Think ...



Think ...

# ...Extrusion

People. Expertise. Plastics. Extrusion is the key technology in plastics manufacturing. FEDDEM is your competent partner for the development, design and construction of extrusion and compounding lines. FEDDEM is known for innovation, which can be found in applications such as the co-rotating twin screw extruder. FEDDEM is valued around the world as a reliable partner for turnkey installations “Made in Germany”. Let us help you to create your new production line. We plan with your needs in mind.



Think ...

# ...Customer

We act with you in mind. We cultivate personal contacts. We listen, in order to fully understand your needs and requirements. We are a reliable team of machine-building enthusiasts with the aim of partnering you for years to come. We deliver just the right engineering solution for you. We are there when you need us.



Think ...

# ...Solution

We plan with your needs in mind. You want to undertake an extrusion task – we are there to help. Global companies and exacting, small-scale manufacturers alike have relied on our know-how for years. As engineering professionals, we provide comprehensive technical support throughout all your project and development phases. As machine-builders, we deliver the best solution for you – turnkey production lines with maximum efficiency for optimal product quality.



Think ...

# ...Product

We take a flexible approach – from material feeding through to the finished, packed plastic product. We develop and supply process components, machines and turnkey production lines. Take advantage of the benefits of successful products such as FEDDEM's FED-MT co-rotating twin screw extruder, as well as our extensive experience with complete compounding lines. Make the choice for solutions that work.



Think ...

# ...Performance

We demand performance. Whether 40 kg or 4 tonnes per hour: FEDDEM lines for high-end or volume products provide wear-resistance, long service life, user-friendliness and efficiency. With FEDDEM production lines, you achieve top product quality with respectable material throughput. You can rely on the guaranteed properties of FEDDEM lines and on our personal service whenever necessary.



Think ...

## ...Technology

We plan one step ahead. We develop and support core technologies in-house – for example, our unique, gentle compounding process in the co-rotating twin screw extruder. In our pilot plant station, we are continually working to further develop screw elements, barrels and material combinations, and to bring innovations such as our new, patent-pending curved die plate – with up to 25 % more nozzles per row – up to market-readiness. Discover new possibilities with FEDDEM.

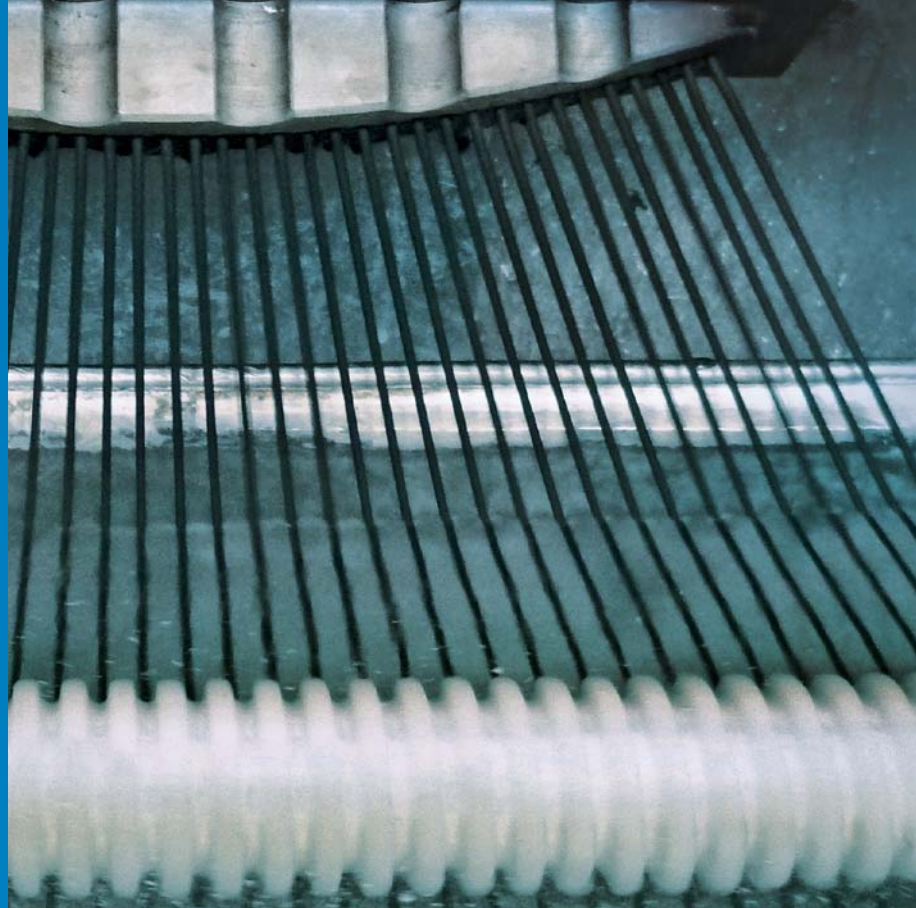

Think ...

# ...Quality

We live quality. Our employees have over 25 years of professional experience. With FEDDEM production lines, you will produce plastic products that meet all current QM requirements. We are certified to the international QM standard DIN ISO 9001 2008. "FEDDEM-Excellence" – our integrated management system – is your guarantee for the highest quality in all our company's operational procedures. We build on the competence of our employees. Social responsibility and the passing on of our knowledge to younger generations are key elements of our company culture.





Think ...

# ...Service

We are there for you. We provide comprehensive technical support throughout all plant engineering phases – with design, CAD/CAE, machine building and functional interfaces to all other machines and equipment. We make production lines tailored to your needs and install turnkey systems on-site. Our pilot plant station is available to you for application consulting and testing. As part of our custom order processing, we guarantee short response times, fast service for repairs and worn parts. Wear measurements of barrels and screw elements complete our service.

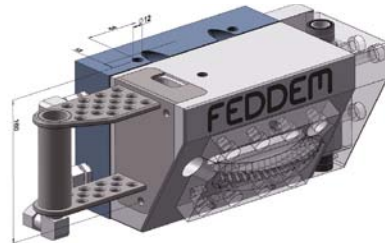

Think ...

## ...Team

We are your team – fast and reliable. We build on the competence of our experienced project and process engineers. By working together in close confidence with our cooperation partners over many years, we are able to offer you individual customer solutions for the planning and set-up of complete production lines – solutions you can rely on. We offer service worldwide. What's more, we are internationally networked with the K.D. Feddersen team. Benefit from the advantages of our strong alliance of mid-sized providers. Grow with us into new markets and countries.



Think ...

# ...Global

We think globally. Take advantage of the Feddersen Group's global network.



Think ...

# ... Value

People. Expertise. Plastics.

FEDDEM offers you high-value solutions for your success.

Talk to us.

[www.feddem.com](http://www.feddem.com)

## Facts

FEDDEM GmbH & Co. KG

- Developer and manufacturer of compounding lines for plastics production
- In-house machine-building
- In-house pilot plant station
- Headquartered in Sinzig, Germany
- Founded in 2009

FEDDEM GmbH & Co. KG  
Mosaikweg 19  
53489 Sinzig  
Germany

Phone: +49 2642 90781-30  
Fax: +49 2642 90781-99

E-Mail: [info@feddem.com](mailto:info@feddem.com)  
Internet: [www.feddem.com](http://www.feddem.com)



**FEDDEM GmbH & Co. KG**  
Member of the Feddersen Group